



SINGLE
MECHANICAL
SEAL

type

H11

Rotary body with bellow and pressed carbon ring, unbalanced, not dependant on the direction of rotation

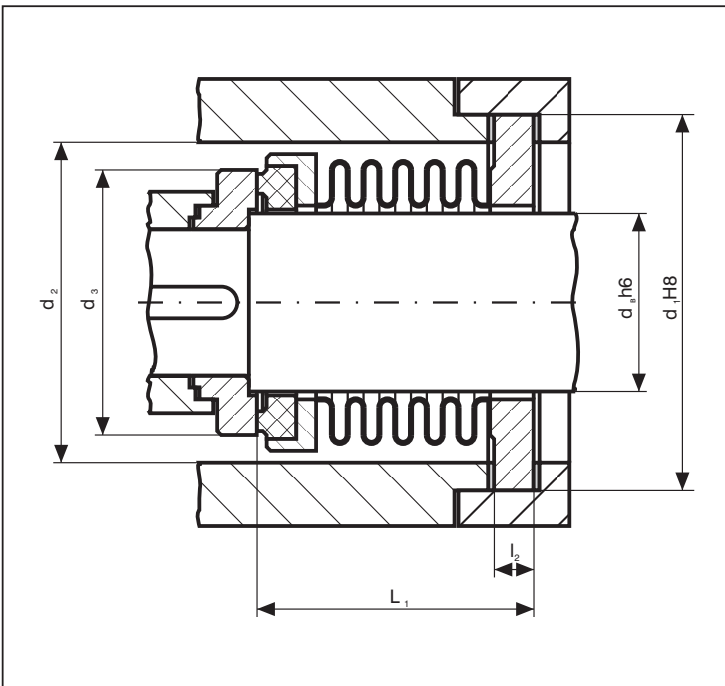

OPERATING PARAMETERS

Pressure: see below table
 Temperature: $t = -190 - +400 \text{ } ^\circ\text{C}$
 Slide Speed: $V_n = 15 \text{ m/s}$

DESIGN'S CHARACTERISTICS

1. Face materials:

- Graphite;
- Ceramic;
- Tungsten Carbide;
- Silicon Carbide;
- Special stainless steels.

2. All metal parts are from stainless steel.

MAIN DIMENSIONS (mm)

d_B	d_1	d_2	d_3	L_1	l_2
26	65	51	44	47,5	7
30	70	60	52	62,5	11
35	80	65	58	62,0	11
40	85	65	60	64,0	11
45	95	75	67	66,0	11
52	105	85	78	76,0	11
55	115	95	83	78,0	11
60	120	100	90	79,5	11
70	125	105	98	80,0	11
90	155	135	122	83,0	11

Permissible pressure according to working temperature (MPa)

-190°C	+20°C	+150°C	+300°C	+400°C
4,0	4,8	4,0	3,3	3,0
3,7	4,4	3,7	3,0	2,7
3,4	4,0	3,4	2,8	2,5
2,8	3,6	2,8	2,0	1,8
2,1	2,5	2,1	1,7	1,6
2,3	2,7	2,3	1,9	1,7
2,1	2,5	2,1	1,7	1,6
1,7	2,0	1,7	1,4	1,3
0,9	1,1	0,9	0,7	0,7
1,1	1,3	1,1	0,9	0,8