

SINGLE
MECHANICAL
SEAL

type

D9K

Construction with rubber bellow, with a central spring, unbalanced, not dependant on the direction of rotation

OPERATING PARAMETERS

Pressure: $P = 0,6 \text{ MPa}$
 Temperature: $t = 120 \text{ }^\circ\text{C}$
 Slide Speed: $V_n = 7 \text{ m/s}$

DESIGN'S CHARACTERISTICS

1. Face materials:

- Graphite;
- Ceramic;
- Tungsten Carbide;
- Silicon Carbide;
- Special stainless steels.

2. Rubber bellow material:

- NBR – till $T = 90 \text{ }^\circ\text{C}$ (gasoline, oil);
- EPDM – till $T = 120 \text{ }^\circ\text{C}$ (water, steam);
- FPM – Viton – till $T = 220 \text{ }^\circ\text{C}$ (oil, aggressive solutions);

3. All metal parts are from special stainless steel.

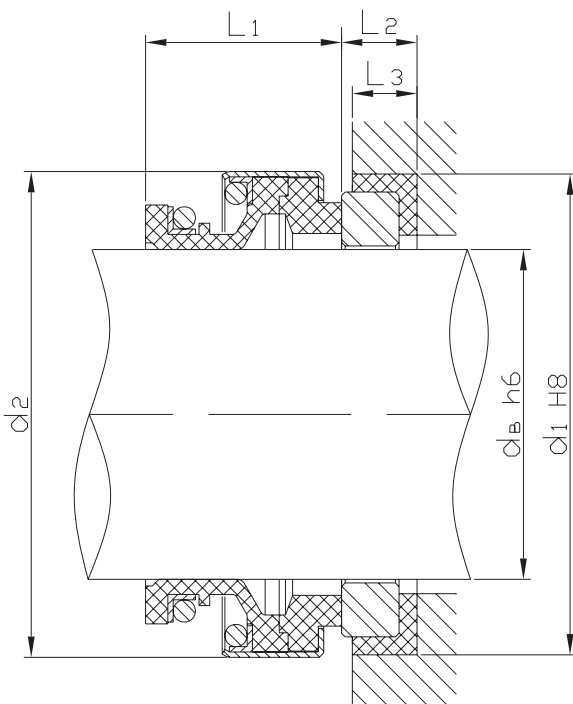

MAIN DIMENSIONS (mm)

d_B	d_1	d_2	L_1	L_2	L_3
12	26	24	11	6	8
20	42	39	13	6	8
24	50	47	14	8	10
25	50	47	14	8	10
30	57	54	15	8	10
35	63	60	16	8	10
38	68	65	17	9	12
40	68	65	17	9	12
45	73	70	20	9	12