

SINGLE  
MECHANICAL  
SEAL

type

**D9F**

Construction with rubber bellow, with a central spring, unbalanced, not dependant on the direction of rotation

**OPERATING PARAMETERS**

Pressure: P = 0,6 MPa  
 Temperature: t = 120 °C  
 Slide Speed: Vn = 7 m/s

**DESIGN'S CHARACTERISTICS**

1. Face materials:

- Graphite;
- Ceramic;
- Tungsten Carbide;
- Silicon Carbide;
- Special stainless steels.

2. Rubber bellow material:

- NBR – till T = 90 °C (gasoline, oil);
- EPDM – till T = 120 °C (water, steam);
- FPM – Viton – till T = 220 °C (oil, aggressive solutions);

3. All metal parts are from special stainless steel.

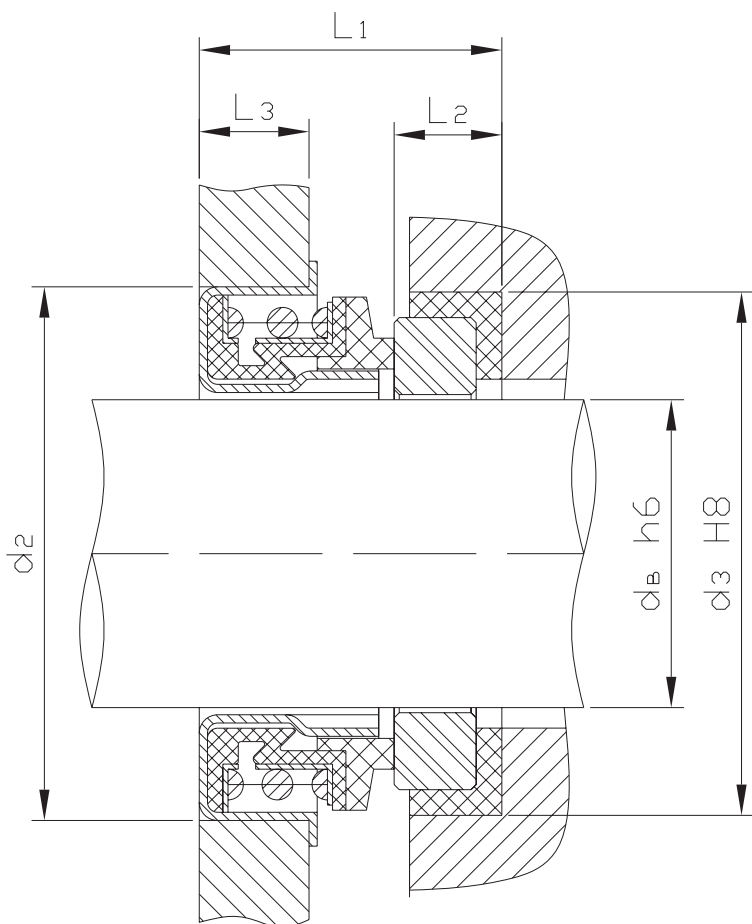

**MAIN DIMENSIONS (mm)**

$d_B$	$d_B$	$d_2$	$d_3$	$L_1$	$L_2$	$L_3$
mm	inch	mm	mm	mm	mm	mm
10	0,375	24,00	23,0	17,0	4,0	7,0
12	0,500	28,55	25,0	18,2	5,0	8,0
16	0,625	36,45	31,0	19,8	5,0	8,0
20	0,750	40,00	35,0	20,5	5,0	9,5
25	1,000	47,00	44,0	25,0	7,0	12,0
30	1,181	52,00	48,0	27,0	8,0	11,0