

type

SINGLE
MECHANICAL
SEAL

D9B

MOUNTING DIMENSIONS ACCORDING
DIN 24 960

Construction with rubber bellow, with a central spring, unbalanced, not dependant on the direction of rotation

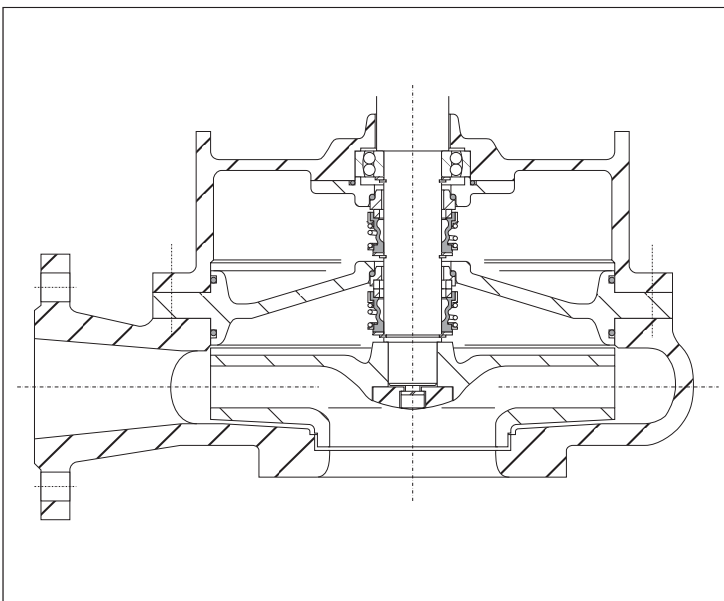
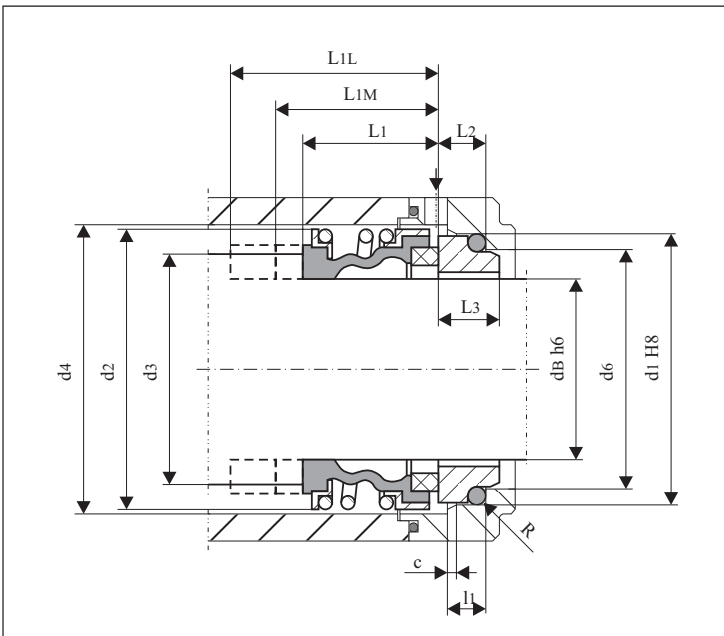

OPERATING PARAMETERS

Pressure: P = 1,0 MPa
Temperature: t = 120 °C
Slide Speed: Vn = 10 m/s

DESIGN'S CHARACTERISTICS

1. Face materials:

- Graphite;
- Ceramic;
- Tungsten Carbide;
- Silicon Carbide;
- Special stainless steels.

2. Secondary seals materials:

- NBR – till T = 90 °C (gasoline, oil);
- EPDM – till T = 120 °C (water, steam);
- FPM – Viton – till T = 220 °C (oil, aggressive solutions);
- PTFE – Teflon – till T = 240°C (high aggressive solutions).

3. All metal parts are from special stainless steel.

Exemplary application of mechanical seals type D9B according scheme "tandem".

MAIN DIMENSIONS (mm)

dB	d1	d2	d3	d4	d6	L1	L1M	L1L	L2	L3	l1	C	R	d12	L22	d13	L23	L33
10	21	24,0	22,5	24	17	14,0	25,9	33,4	6,6	9,0	5,0	1,2	1,2	24	8,5	-	-	-
12	23	24,0	22,5	26	19	14,0	25,9	33,4	5,6	8,0	5,0	1,2	1,2	26	8,5	-	-	-
14	25	28,0	26,0	30	21	16,0	28,4	33,4	5,6	8,0	5,0	1,2	1,2	28	8,5	-	-	-
15	-	28,0	26,0	30	-	17,0	28,4	33,4	-	-	-	-	1,2	-	-	24,6	10,0	12,5
16	27	28,0	26,0	30	23	17,0	28,4	33,4	7,5	10,0	6,5	1,5	1,5	32	8,5	28,0	10,0	12,5
18	33	31,0	29,0	33	27	18,0	30,0	37,5	8,0	10,5	6,5	1,5	1,5	35	9,5	30,0	10,5	13,5
20	35	36,0	33,0	38	29	21,0	30,0	37,5	7,5	10,0	6,5	1,5	1,5	38	9,5	35,0	10,5	13,5
22	37	36,0	33,0	38	31	21,0	30,0	37,5	7,5	10,0	6,5	1,5	1,5	38	9,5	35,0	10,5	13,5
24	39	40,5	37,0	44	33	22,5	32,5	42,5	7,5	10,0	6,5	1,5	1,5	42	9,5	38,0	10,5	13,5
25	40	41,0	37,0	44	34	22,5	32,5	42,5	7,5	10,0	6,5	1,5	1,5	42	9,5	38,0	10,5	13,5
28	43	47,0	44,0	50	37	26,0	35,0	42,5	9,0	11,5	6,5	1,5	1,5	46	9,5	42,0	11,0	14,0
30	45	47,0	44,0	50	39	26,0	35,0	42,5	10,5	13,0	6,5	1,5	1,5	48	9,5	45,0	11,0	14,0
32	48	51,0	46,0	55	42	26,0	35,0	47,5	10,5	13,0	6,5	1,5	1,5	54	9,5	48,0	11,0	14,0
33	48	51,0	46,0	55	42	26,0	35,0	47,5	11,0	13,5	6,5	1,5	1,5	54	9,5	50,0	11,0	14,5
35	50	55,0	50,0	59	44	27,0	35,0	47,5	11,0	13,5	6,5	1,5	1,5	54	9,5	52,0	11,5	14,5
38	56	58,0	53,0	61	49	28,0	36,0	46,0	10,3	13,0	6,5	1,5	1,5	57	12,0	55,0	11,5	14,5
40	58	60,0	55,0	64	51	28,0	36,0	46,0	10,8	13,5	6,5	1,5	1,5	60	12,0	58,0	11,5	14,5
43	61	63,0	58,0	67	54	28,0	36,0	51,0	12,0	14,5	8,0	2,0	2,5	64	12,0	62,0	14,3	17,0
45	63	65,0	60,0	70	56	28,0	36,0	51,0	11,6	14,5	8,0	2,0	2,5	64	12,0	64,0	14,3	17,0
48	66	69,0	63,0	74	59	29,0	36,0	51,0	11,6	14,5	8,0	2,0	2,5	66	12,0	68,4	14,3	17,0
50	70	71,0	65,0	77	62	29,0	38,0	50,5	11,6	14,5	8,0	2,0	2,5	70	12,5	69,3	14,3	17,0
53	73	76,0	70,0	81	65	32,0	36,5	59,0	12,3	15,0	8,0	2,0	2,5	73	12,5	72,3	15,3	18,0
55	75	78,0	72,0	83	67	34,0	36,5	59,0	13,3	16,0	8,0	2,0	2,5	75	12,5	75,4	15,3	18,0
58	78	82,0	75,0	88	70	36,0	41,5	59,0	13,3	16,0	8,0	2,0	2,5	80	12,5	78,4	15,3	18,0
60	80	85,0	79,0	91	72	38,0	41,5	59,0	13,3	16,0	8,0	2,0	2,5	80	12,5	80,4	15,3	18,0
65	85	90,0	84,0	96	77	38,0	41,5	69,0	13,0	16,0	8,0	2,0	2,5	90	12,5	85,4	15,3	18,0
68	90	94,0	88,0	100	81	38,0	41,2	68,7	13,7	16,0	8,0	2,0	2,5	90	12,5	91,5	16,3	19,0
70	92	97,0	90,0	103	83	38,0	48,7	68,7	13,0	16,0	8,0	2,0	2,5	95	14,5	92,0	15,3	18,0
75	97	102,0	95,0	110	88	40,0	48,7	68,7	14,0	17,0	8,0	2,0	2,5	100	14,5	99,0	16,3	19,0
80	105	108,0	100,0	116	95	40,0	48,0	78,0	15,0	17,5	8,0	2,0	2,5	105	16,0	104,0	16,3	19,0
85	110	116,0	107,0	124	100	40,0	46,0	76,0	14,8	17,5	10,0	2,0	2,5	110	16,0	109,0	16,3	19,0
90	115	123,0	114,0	131	105	43,5	51,0	76,0	14,8	17,5	10,0	2,0	2,5	115	16,0	114,0	16,3	19,0
95	120	128,0	119,0	136	110	43,5	51,0	76,0	15,8	18,5	10,0	2,0	2,5	120	16,0	120,3	16,3	19,0
100	125	133,0	124,0	140	115	43,5	51,0	76,0	15,8	18,5	10,0	2,0	2,5	125	16,0	123,3	16,3	19,0

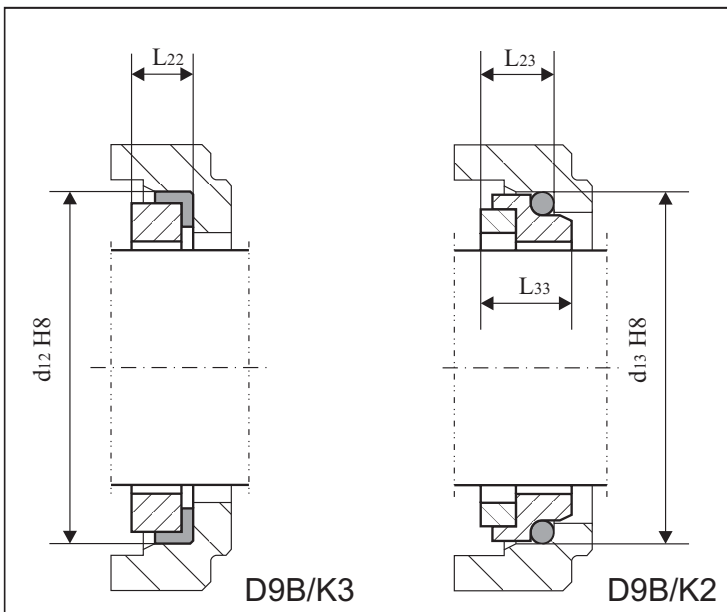

REMARKS:

1. Tolerances of L1 are as follows:

- For d b=10 – 50mm: +/- 0,5 mm.
- For d b=50 – 100mm: +/- 0,8 mm

It is recommended to use stationary rings type: K1,K2,K3,K4,K5,K6,K7,K8