



type

SINGLE
MECHANICAL
SEAL

D3__S

MOUNTING DIMENSIONS ACCORDING
DIN 24 960

Unbalanced, with a central spring, dependent on the direction of rotation.
Stationary ring could be fixed or not fixed with pin against turning.
The combination between rings of D300, D320 and D377 are used.

OPERATING PARAMETERS

Pressure:	P = 1,0 MPa
Temperature:	t = 220 °C
Slide Speed:	Vn = 20 m/s
	D377S Vn = 10 m/s

DESIGN'S CHARACTERISTICS

1. Face materials:

- Carbon;
- Ceramic;
- Tungsten Carbide;
- Special Stainless Steel;
- Silicon Carbide.

2. Secondary seals materials:

- NBR – till T = 90 °C (gasoline, oil);
- EPDM – till T = 120 °C (water, steam);
- FPM – Viton – till T = 220 °C (oil, aggressive solutions);
- PTFE – Teflon – till T = 240°C (high aggressive solutions).

3. All metal parts are from special stainless steel.

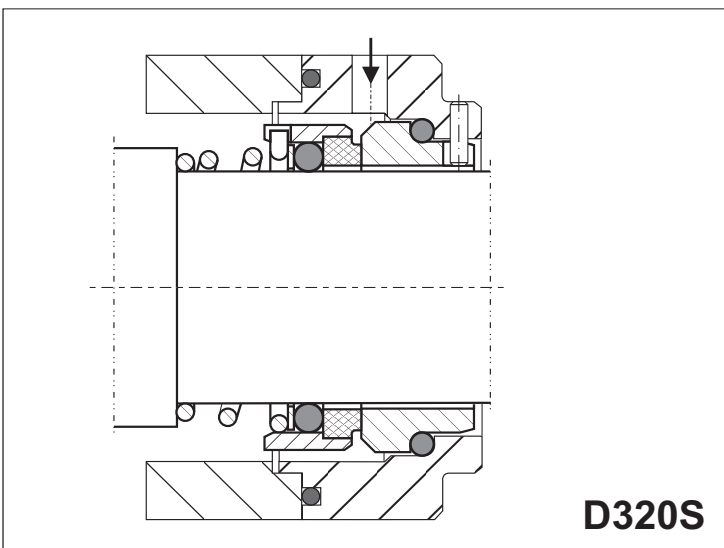
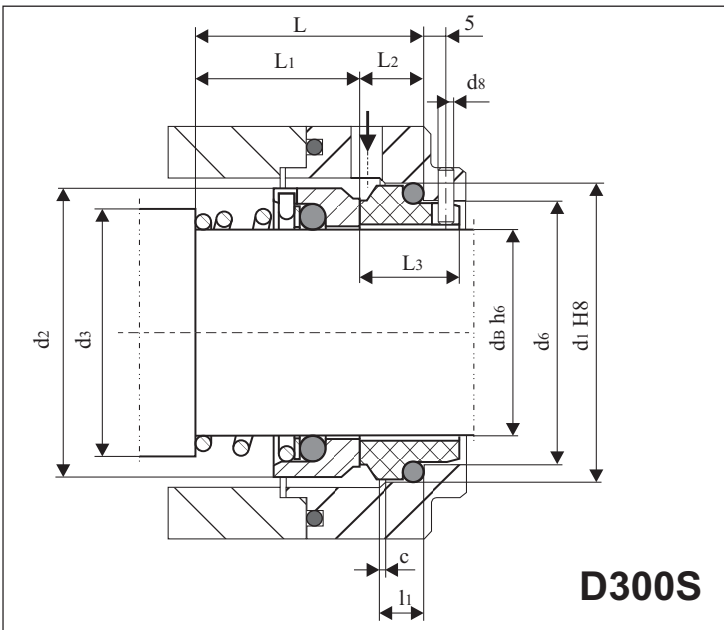

MAIN DIMENSIONS (mm)

DB	d1	d2	d3	d6	L	L1	L2	L3	l1	C	L12
10	21	20	14	17	25,5	15,5	10,0	17,5	5,5	1,5	3
12	23	22	16	19	26,0	16,0	10,0	17,5	5,5	1,5	3
14	25	24	18	21	26,5	16,5	10,0	17,5	5,5	1,5	3
16	27	26	21	23	28,0	18,0	10,0	17,5	5,5	1,5	3
18	33	31	23	27	31,0	19,5	11,5	19,5	7,0	2,0	3
20	35	34	26	29	33,5	22,0	11,5	19,5	7,0	2,0	3
22	37	36	28	31	33,0	21,5	11,5	19,5	7,0	2,0	3
24	39	38	30	33	35,0	23,5	11,5	19,5	7,0	2,0	3
25	40	39	31	34	38,0	26,5	11,5	19,5	7,0	2,0	3
28	43	42	35	37	38,0	26,5	11,5	19,5	7,0	2,0	3
30	45	44	37	39	38,0	26,5	11,5	19,5	7,0	2,0	3
32	48	46	39	42	40,0	28,5	11,5	19,5	7,0	2,0	3
33	48	47	40	42	40,0	28,5	11,5	19,5	7,0	2,0	3
35	50	49	43	44	40,0	28,5	11,5	19,5	7,0	2,0	3
38	56	54	45	49	47,5	33,5	14,0	22,0	8,0	2,0	4
40	58	56	49	51	50,0	36,0	14,0	22,0	8,0	2,0	4
43	61	59	52	54	52,5	38,5	14,0	22,0	8,0	2,0	4
45	63	61	55	56	53,5	39,5	14,0	22,0	8,0	2,0	4
48	66	64	58	59	60,0	46,0	14,0	22,0	8,0	2,0	4
50	70	66	61	62	60,0	45,0	15,0	22,5	8,5	2,5	4
53	73	69	64	65	62,0	47,0	15,0	22,5	8,5	2,5	4
55	75	71	66	67	64,0	49,0	15,0	22,5	8,5	2,5	4
58	78	78	69	70	70,0	55,0	15,0	22,5	8,5	2,5	4
60	80	79	71	72	70,0	55,0	15,0	22,5	8,5	2,5	4
63	83	83	74	75	70,0	55,0	15,0	22,5	8,5	2,5	4
65	85	85	77	77	70,0	55,0	15,0	22,5	8,5	2,5	4
68	90	88	80	81	73,0	55,0	18,0	25,5	9,5	2,5	4
70	92	90	83	83	75,0	57,0	18,0	25,5	9,5	2,5	4
75	97	98	88	88	80,0	62,0	18,0	25,5	9,5	2,5	4
80	105	103	93	95	80,0	61,8	18,2	25,5	10	3,0	4

REMARKS:

1. Tolerances of L1 = +/- 1 mm.

2. When ordering please define direction of shaft's rotation (View of stationary ring's side – the shaft is with right direction of rotation if it rotates clockwise direction).

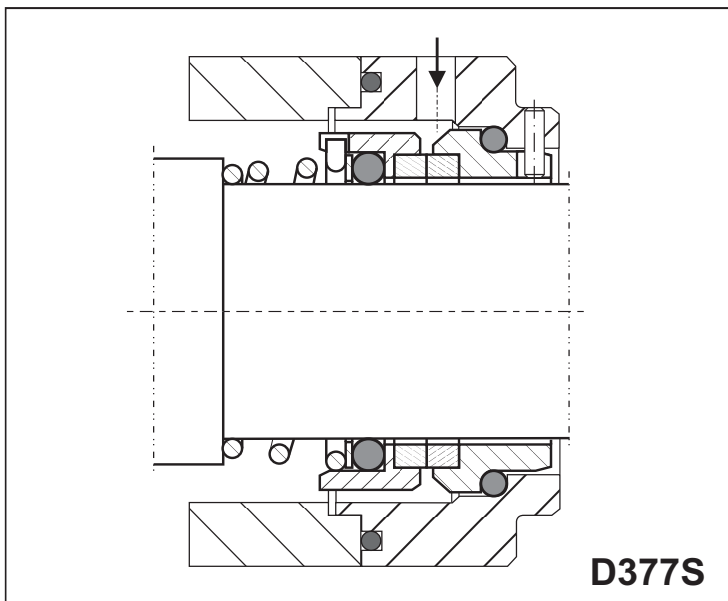

D377 is manufactured and in following versions: D370S, D307S, D327S